

HoleBore™ FIXINGS INSTALLER

Typical Applications:

- For use with most fixings into plasterboard.
- Small sizes also suitable for use in thin plywood panels.



1. Pierces plasterboard easily and cleanly.



2. Blade sizes for most fixing requirements.

- Fast, easy way to install fixings in plasterboard walls and ceilings.
- Eliminates the need for a drill and screwdriver.
- 5 blade sizes for most fixings requirements.
- Tool with interchangeable blades includes Pozi Driv and flat screwdriver head.

Product Specification

DESC.	BLADE SIZES (mm)
HoleBore™ + Interchangeable Blades & Screwdriver Bit	Clip of 5 sizes: 5,6,7,8,10mm
Replacement Blades	Clip of 5 sizes: 5,6,7,8,10mm
HoleBore™ - Fixed Blade	5mm
HoleBore™ - Fixed Blade	6mm
HoleBore™ - Fixed Blade	7mm
HoleBore™ - Fixed Blade	8mm

Various packs of fixings and a HoleBore™ Fixings Installer also available.

How to Use

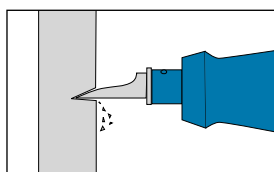

1. Using appropriate size HoleBore™ for the fixing, push the tip into the substrate. Apply even pressure whilst twisting alternately clockwise and anti-clockwise until the bore passes through the substrate. Withdraw HoleBore™ from hole.

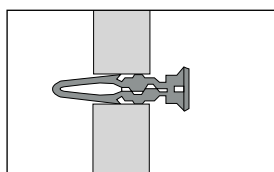

2. Insert fixing.

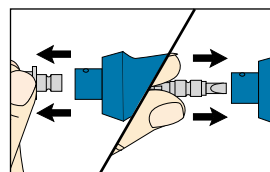

3. Remove the blade from the HoleBore™ handle and replace with screwdriver bit provided.

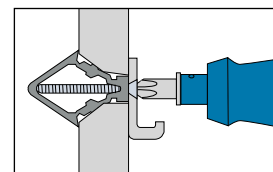

4. Tighten until secure.